

# AP-TRIMODE ANTENNA - EUROPE

**AP90/17/21/GPS**

## **Cellular and GPS Together In One Package**

**The AP-TriMode Antenna** is the low profile Cellular and GPS combination external antenna. Everything is in the one housing, reducing the need for multiple antennas and holes being drilled. With the built in ground plane, this antenna can be used on non-metal surfaces, and still provide optimal performance for the cellular reception.

### **Key Benefits:**

#### **Bigger Wireless Footprint**

The AP-TriMode Antenna provides up to 25% more wireless coverage, depending on the geography you travel in.

#### **Faster Data Speeds**

Better reception translates to faster speeds. The data gets through the first time, correctly.

#### **Long Product Life – Low Profile Design**

The AP-TriMode Antenna is very durable. It withstands all of the natural elements, car washes, and being swept by tree branches.

#### **Mounting Choices**

Mounting styles include: permanent adhesive, threaded bolt and Dual-NMO; as well as magnetic mount for less permanent requirements. A metal ground plane can be built in for use with fiberglass vehicles.

#### **One Simple Installation**

The AP-TriMode Antenna has all of the antennas in the one housing. This means you only have one hole to drill and one installation effort.

#### **Antenna Plus Connects to . . .**

Wireless Data Cards, Ruggedized Computers with Embedded Wireless, Docking Stations, Ruggedize Modems, Mobile Access Routers and more.



### **Extra coverage gained with the AP-TriMode Antenna**

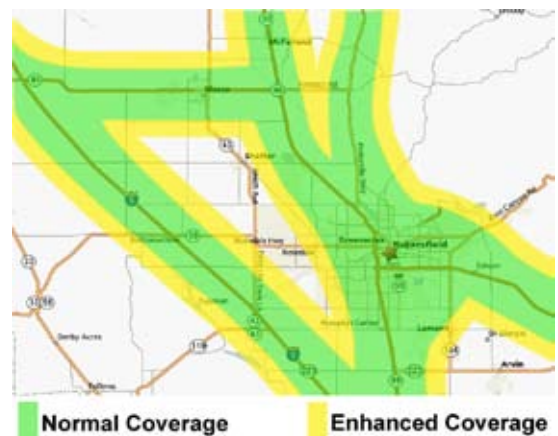

## AP-TriMode Antenna

### AP-TriMode Antenna Dimensions (AP90/17/21/GPS)

#### Electrical Specifications

**Frequencies:**

- F1 = 890-950 MHz
- F2 = 1710-1880 MHz
- F3 = 2110-2170 MHz

**VSWR:** 1.5:1 or less at resonant point

**Gain:** 3.0 dBi

**Radiation Pattern:**

- OMNI Directional
- Hemispherical (GPS)

**Polarization:**

- Vertical

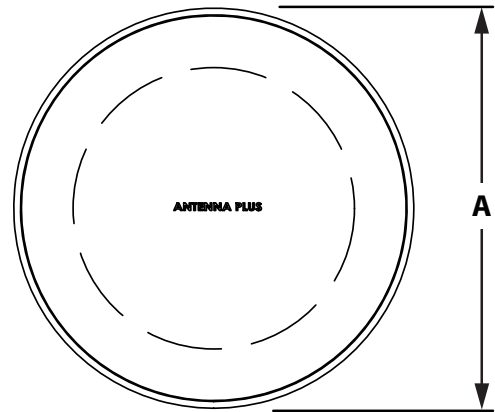

#### Mechanical Specifications

**Radome:**

- Glass Filled Polypropylene

**Cable Length:**

- 15 feet / 4.5m (Adhesive Mount)
- 10 feet / 3m (Magnetic Mount)

**Connectors:**

- Contact factory for connector options.

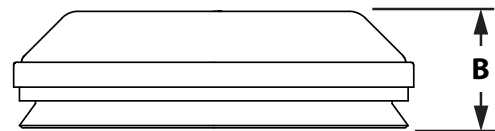

<b>A</b>	4.4 in. / 112mm
<b>B</b>	1.3 in. / 33mm

#### GPS Antenna Specifications

- Center Frequency . . . 1575.42 MHz
- Gain . . . . . 30 dBi min.
- Polarization . . . . . R.H.C.P.  
Right Hand Circular Polarization
- Noise Figure . . . . . 2.0 max.
- Arial Ratio. . . . . 3 dBi max.
- Bandwidth . . . . . 2 MHz min.
- VSWR . . . . . 2.0 max.
- Output Impedance . . . 50 Ohms
- Voltage . . . . . 3-5 Volts
- Current . . . . . 15 mA (max)

**RoHS Compliant**

